

MAIN FEEDER DIAGRAM

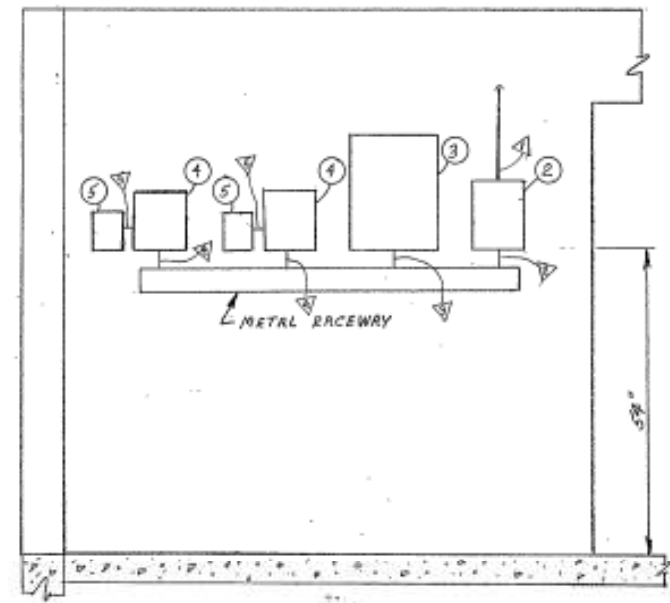

ELEVATION- DISCONNECT AND PANEL MOUNTING

ELECTRICAL EQUIPMENT NOTES

- ① SERVICE ENTRANCE: WEATHERHEAD AND RISER. INSTALL METER SOCKET FURNISHED BY IOWA ELECTRIC CO. IDENTIFY THE PHASE CONDUCTOR HAVING THE HIGHER VOLTAGE TO GROUND WITH AN OUTER FINISH ORANGE IN COLOR OR BY TAGGING.
- ② MAIN DISCONNECT: ITC HEAVY DUTY FUSIBLE DISCONNECT, 3-POLE, SOLID NEUTRAL, 3-FUSE, 240 VOLT, 100 AMP, NEMA 1 ENCLOSURE.
- ③ PANEL-L: ITC SINGLE PHASE 120/240 VOLT PANEL BOARD WITH 100 AMP MAIN BREAKER, 2-2 POLE 15 AMP BREAKERS, 4-1 POLE 15 AMP BREAKERS AND 6-PROVISIONS.
- ④ MOTOR DISCONNECT: ITC HEAVY DUTY FUSIBLE DISCONNECT, 3-POLE, SOLID NEUTRAL, 3-FUSE, 240 VOLT, 60 AMP, NEMA 1 ENCLOSURE.
- ⑤ MOTOR STARTER: ALLEN-BRADLEY BULLETIN 609 MANUAL STARTING SWITCH, SIZE 1, PUSH BUTTON, 3-ME3 HEATER ELEMENTS, NEMA 1 ENCLOSURE.
- ⑥ INDUSTRIAL TYPE 4-TUBE FLUORESCENT FIXTURE, 120 VOLT, 4-F40 TUBES, MOUNT TO UNDERSIDE OF FINISHED CEILING. CONTROL WITH SINGLE 120 VOLT, 1-POLE SWITCH MOUNTED 48" ABOVE FLOOR SURFACE.
- ⑦ DUPLEX OUTLET WITH WEATHERPROOF COVER. MOUNT AT 48" ABOVE FLOOR SURFACE.
- ⑧ EXISTING 120 VOLT TRANSFER SWITCH. RELOCATE FROM RADIO SHED.
- ⑨ EXISTING GENERATOR. RELOCATE FROM RADIO SHED.
- ⑩ PUMP MOTOR: 7.5 HP, 240 VOLT, 3-PHASE, 60 HS, HIGH EFFICIENCY AC MOTOR.
- ⑪ BASEBOARD HEATER UNIT, 240 VOLT, 1000 WATT, AC.

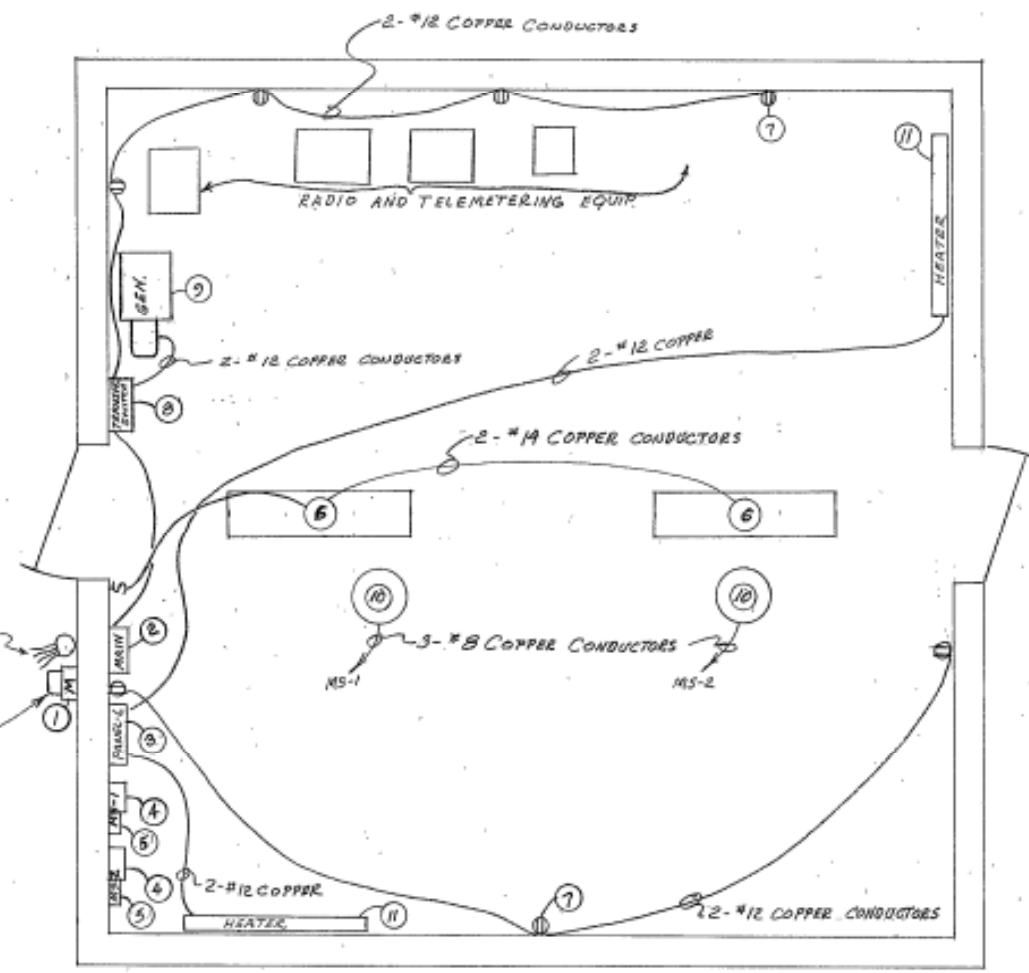

PLAN - ELECTRICAL

GENERAL WIRING NOTES

1. ALL WIRING TO BE IN ACCORD WITH THE CEDAR RAPIDS ELECTRICAL CODE AND THE NATIONAL ELECTRICAL CODE.
2. PROVIDE SYSTEM GROUND ELECTRODE NEAR SERVICE ENTRANCE.
3. ALL CONDUCTORS SHALL BE RATED 600 VOLT, TYPE THW OR SHW, COPPER WIRE.
4. ALL WIRING BETWEEN FIXTURES AND EQUIPMENT IS TO BE IN STEEL OR ALUMINUM CONDUIT. FEEDER WIRING FROM MAIN DISCONNECT TO LIGHTING PANEL AND MOTOR DISCONNECTS SHALL BE IN METAL RACEWAY. LIQUID-TIGHT FLEXIBLE CONDUIT SHALL BE USED FOR MAKING CONNECTIONS TO MOTORS AND GENERATORS.
5. ALL FIXTURES, PANELS, RECEPTACLES, CONTROLS, MOTORS, GENERATORS, DISCONNECT SWITCHES AND NON-CURRENT CARRYING METAL ENCLOSURES SHALL BE CONNECTED TO THE SYSTEM GROUND PER NEC.
6. DISCONNECTS, LIGHTING PANELS, MOTOR STARTERS, HEATING UNITS AND RECEPTACLES SHALL BE SURFACE MOUNTED.

FEEDER SCHEDULE

- ▲ 3-#3 COPPER, 1-#6 COPPER GROUND
- ▲ 6-#8 COPPER, 2-#10 COPPER, 1-#10 COPPER GROUND
- ▲ 2-#10 COPPER, 1-#10 COPPER GROUND
- ▲ 3-#8 COPPER
- ▲ 3-#8 COPPER

CEDAR RAPIDS WATER DEPARTMENT 1111 SHAWVER ROAD N.E. CEDAR RAPIDS, IOWA			
DATE	BY	REVISED	DATE
3-31-88	LEC		
PROJECT		NO.	
GLASS RD PUMP STA		880303	